

**SPID Azimuth antenna  
rotator  
Model: BIG-RAK**

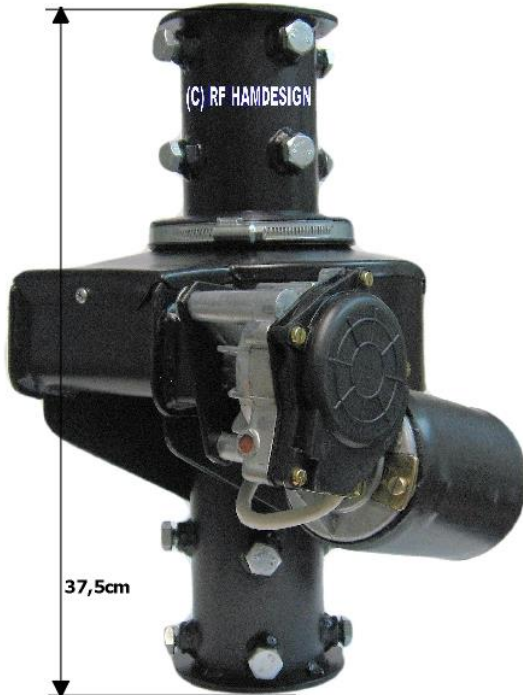

Normal 360  
- 180  
or  
+540 from  
North 0  
for  
total of 720

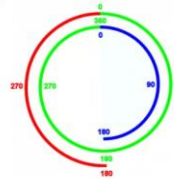

<b>Specifications: SPID BIG RAK Azimuth Rotator</b>	<b>BIG RAK @ 12V</b>	<b>BIG RAK @ 18V</b>
Turning torque in-lbs/Nm	2,800 in lb/315 Nm	3,600 in lb/403 Nm
Brake Torque in lbs/Nm	24,000 in lb/2,712 Nm	24,000 in lb/2,712 Nm
Brake Construction	Double Worm Gears	Double Worm Gears
Vertical Load lbs/Kg	>700 lbs/318 Kg	>700 lbs/318 Kg
Rotation Speed (360 Deg)	210 sec	140 sec (24V 100 sec)
Resolution	0.5 deg	0.5 deg
Rotation Range Az/EI	360 deg	360 deg
Weight lbs / Mass Kg	26.5 lbs/12 Kg	26.5 lbs/12 Kg
Position Sensor	Reed Switch	Reed switch
Mast size inches/mm bottom/top mount	2.6 in/66 mm	2.6 in/66 mm
Environment	Ground / Mobile free air and / or Sheltered	
MTBF	12500 hours @ -20 to 55°C	
Control cable core	4	4

Alle leveringen dienen te worden betaald binnen 30 dagen na factuurdatum. Voor alle door ons gesloten overeenkomsten, leveringen en diensten gelden onze algemene verkoop en leveringsvoorwaarden welke op [www.rfhamdesign.com](http://www.rfhamdesign.com) zijn vermeld.  
All transactions, deliveries and services are subject to the terms and conditions of delivery which can be found at [www.rfhamdesign.com](http://www.rfhamdesign.com)

RF HAMDESIGN is ingeschreven in het handelsregister K.v.K. te Leeuwarden Nr: 01107005  
RF HAMDESIGN is written in at the Chamber of Commerce in Leeuwarden, the Netherlands Nr: 01107005

<b>Specifications Controller:</b>	
Supply voltage	12 to max 18 Volt
Current consumption	3.....5 A
Supplied including	<ul style="list-style-type: none"> <li>• Digital controller</li> <li>• Build in PC track interface (USB)</li> <li>• Software</li> <li>• Mouse</li> <li>• USB cable</li> <li>• Fast setup sheet</li> </ul>
Option PWM (soft start/stop)	No
Dimensions	220x125x40mm
Weight:	0.9 Kg
Case	Aluminium / steel
Environment	Ground / Mobile Sheltered
MTBF	15000 hours @ -5 to +40°C
Display	4 digit (green)
Control cable 8-core	Connection inc. 1* 4 pin-DIN connector

**RF HAMDESIGN & Spid Controllers will support the following software:**

- ✓ PST Rotor (Also /HR controllers MD-0X)
- ✓ MacDoppler (MacDoppler Ham Radio Satellite Tracking for Macintosh)
- ✓ N1MM Logger
- ✓ Ham Radio Deluxe
- ✓ Logic 7 Version => 7.0.45
- ✓ Orbiton Satallite Tracking
- ✓ Gpredict Satallite Tracking Linux and MAC
- ✓ SatPC32 Satallite Tracking - works on windows only
- ✓ DXLab (DX View)
- ✓ TRXmanager

**Most software should also work if it supports Yaesu type rotators !**

**Note:**

#1 Software may have new versions and some options may have changed

#2 We have not tested all this software !

#3 Most software is for use with Rot2Prog (Dual-Ax rotor AZ&EL), but some also work with the single Ax rotor system Rot1Prog.

Alle leveringen dienen te worden betaald binnen 30 dagen na factuurdatum. Voor alle door ons gesloten overeenkomsten, leveringen en diensten gelden onze algemene verkoop en leveringsvoorwaarden welke op [www.rfhamdesign.com](http://www.rfhamdesign.com) zijn vermeld.  
All transactions, deliveries and services are subject to the terms and conditions of delivery which can be found at [www.rfhamdesign.com](http://www.rfhamdesign.com)

RF HAMDESIGN is ingeschreven in het handelsregister K.v.K. te Leeuwarden Nr: 01107005  
RF HAMDESIGN is written in at the Chamber of Commerce in Leeuwarden, the Netherlands Nr: 01107005

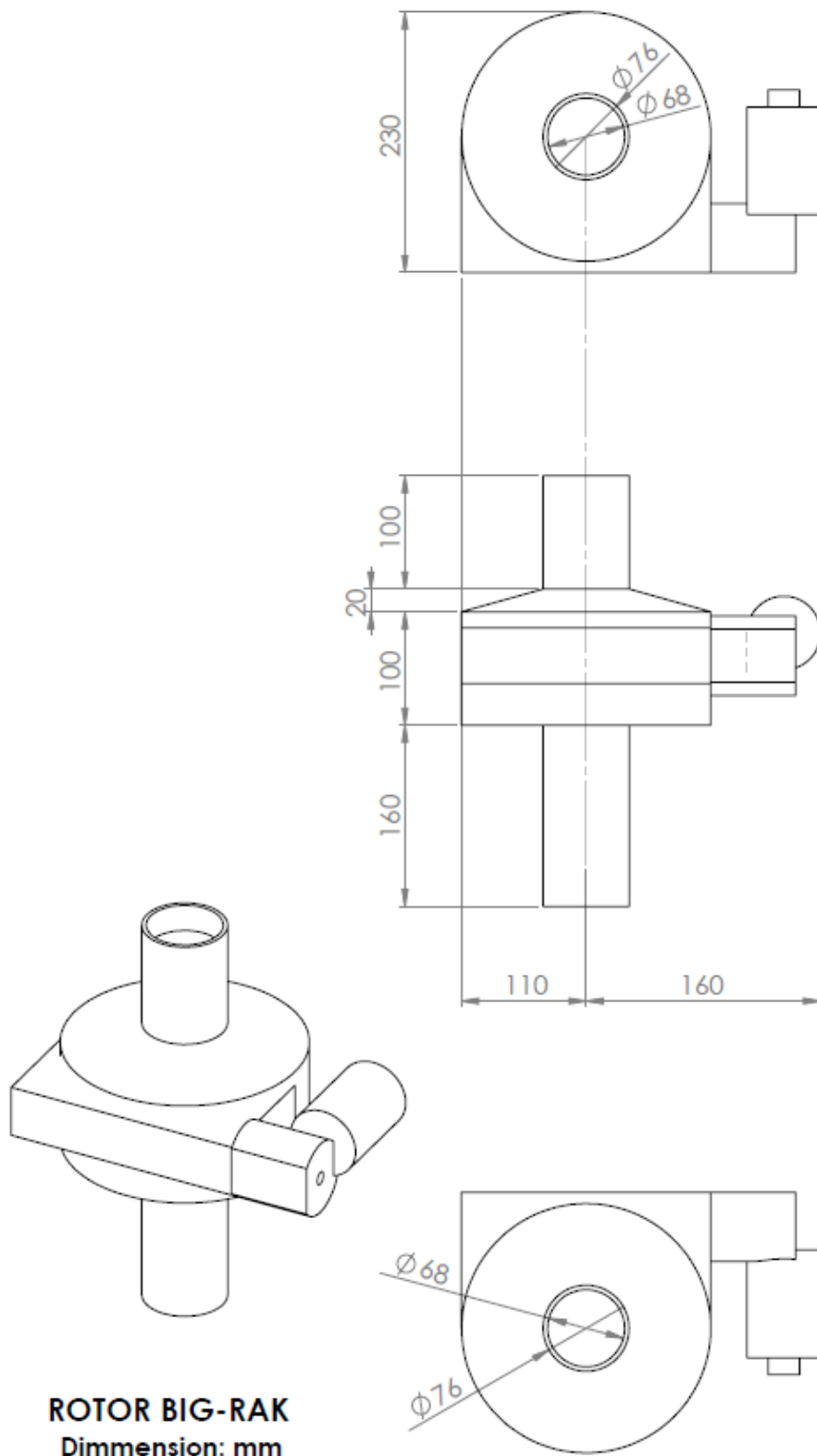



**ROTOR BIG-RAK**  
 Dimmension: mm

Alle leveringen dienen te worden betaald binnen 30 dagen na factuurdatum. Voor alle door ons gesloten overeenkomsten, leveringen en diensten gelden onze algemene verkoop en leveringsvoorwaarden welke op [www.rfhamdesign.com](http://www.rfhamdesign.com) zijn vermeld. All transactions, deliveries and services are subject to the terms and conditions of delivery which can be found at [www.rfhamdesign.com](http://www.rfhamdesign.com)

RF HAMDESIGN is ingeschreven in het handelsregister K.v.K. te Leeuwarden Nr: 01107005  
 RF HAMDESIGN is written in at the Chamber of Commerce in Leeuwarden, the Netherlands Nr: 01107005

## Available accesories

Accessories	Type	
<b>Control cable 4-core (4x1,5sq.mm) and (4x0.7sq.mm)</b>  Reel: 25meter / 50 meter	<b>CC4-002/25</b>	
<b>SPID ADAPTOR Plate</b>  Used to Mount the rotator at a base-plate	<b>SPID-ADAPT</b>	
<b>Power Supply Unit</b>  16,5 Volt / 10 Amp (150W)  Dim: 19 x 11 x 5 cm (LxBxH)	<b>PW-15015LC</b>	

**Note:** Prices can be found in our price list, download link at our web-site: [www.rfhamdesign.com](http://www.rfhamdesign.com) **All**

### SPID Rotators are supplied incl:

- ✓ Controller incl. build in track interface (USB)
- ✓ Special mouse to control AZ / AZ & EL Ax
- ✓ USB Cable
- ✓ Connectors
- ✓ CD-Rom
- ✓ Quick start guide

Alle leveringen dienen te worden betaald binnen 30 dagen na factuurdatum. Voor alle door ons gesloten overeenkomsten, leveringen en diensten gelden onze algemene verkoop en leveringsvoorwaarden welke op [www.rfhamdesign.com](http://www.rfhamdesign.com) zijn vermeld.  
 All transactions, deliveries and services are subject to the terms and conditions of delivery which can be found at [www.rfhamdesign.com](http://www.rfhamdesign.com)

RF HAMDESIGN is ingeschreven in het handelsregister K.v.K. te Leeuwarden Nr: 01107005  
 RF HAMDESIGN is written in at the Chamber of Commerce in Leeuwarden, the Netherlands Nr: 01107005

## Dimension SPID ADAPTOR Plate

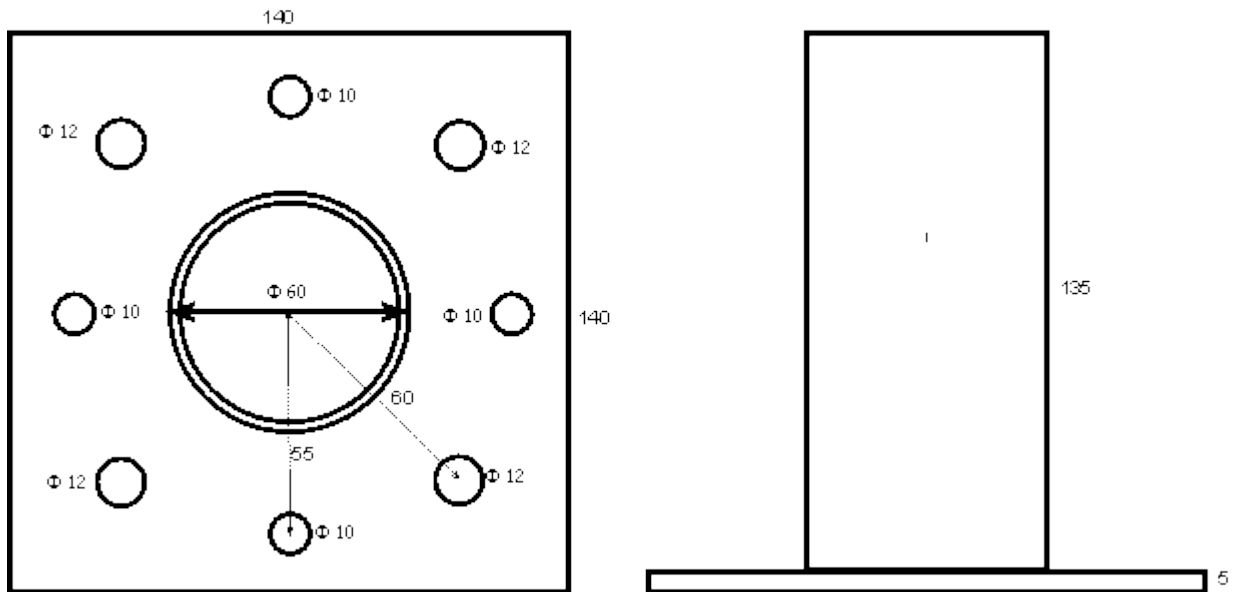

Alle leveringen dienen te worden betaald binnen 30 dagen na factuurdatum. Voor alle door ons gesloten overeenkomsten, leveringen en diensten gelden onze algemene verkoop en leveringsvoorwaarden welke op [www.rfhamdesign.com](http://www.rfhamdesign.com) zijn vermeld.  
All transactions, deliveries and services are subject to the terms and conditions of delivery which can be found at [www.rfhamdesign.com](http://www.rfhamdesign.com)

RF HAMDESIGN is ingeschreven in het handelsregister K.v.K. te Leeuwarden Nr: 01107005  
RF HAMDESIGN is written in at the Chamber of Commerce in Leeuwarden, the Netherlands Nr: 01107005